

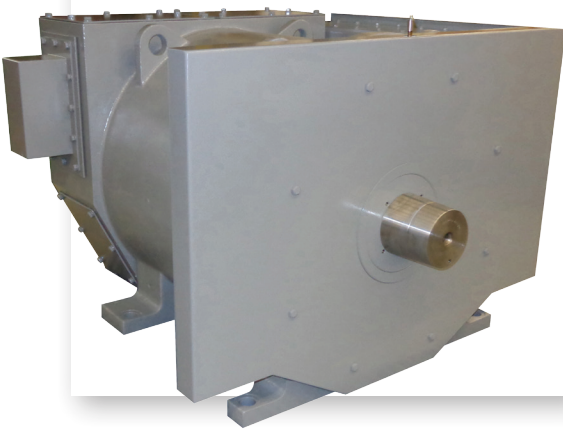

# Ward Leonard

Excellence in Motor and Control Solutions™

## 1,500 HP AC Drilling Motor – WL29BC150



### Benchmark Performance for Oil & Gas Applications

The Ward Leonard 1,500 HP (WL29BC150) AC Motor is designed to deliver or exceed customer specifications for performance, productivity and durability. Engineered to withstand decades of continuous service, this rugged 1,500 HP motor is ideally suited for mud pumps and draw works in the extreme environments where oil and gas rigs operate either on or off-shore.

#### Standard Features

- ♦ 6 pole stator with form wound windings
- ♦ Extra tough pitch copper rotor bars
- ♦ Certified Class H insulation
  - Robotically taped Mica-Kapton
  - Fully vacuum impregnated (VPI)
  - Tested for 4 hours under water at 500 V
- ♦ 4340 alloy shafts
- ♦ Six 100Ω platinum RTDs; 2/phase embedded in stator

- ♦ Right or left blower and junction box positions
- ♦ Designed for Variable Frequency Drive operation
- ♦ Heater
- ♦ Double shaft extension (tapered, splined or keyed)
- ♦ ATEX and CSA-approved

#### Optional Features

- ♦ Encoder
- ♦ Bearing RTD
- ♦ Blower assembly
- ♦ Air pressure switch
- ♦ IP 56 junction box
- ♦ IP 44 motor enclosure
- ♦ Insulated bearing on non-drive end
- ♦ ABS and DNV



# 1,500 HP AC Drilling Motor



## Speed - Torque Performance That Leads the Industry

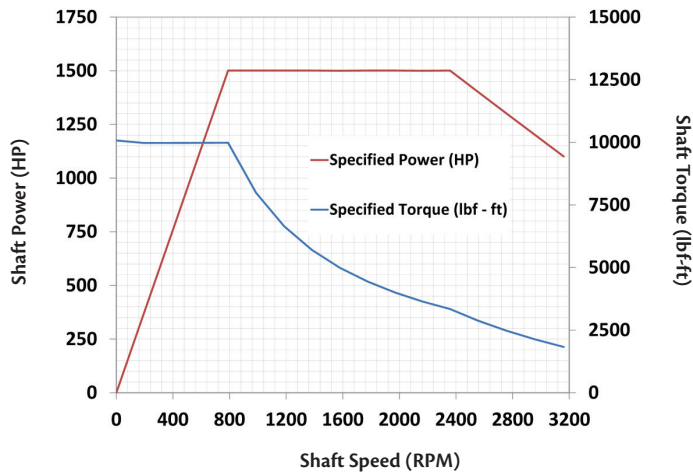

## Critical Data

Model number	WL29BC150
Voltage (AC)	560 $\pm$ 10% ***
Current (Amps)	1630
Rated Speed	788 RPM
Torque (lb ft)	10,000 at rated speed
HP	1500 at rated speed
Max. permissible speed	3200 RPM **
Base motor weight	7,400 lbs.
Rotor weight	2,250 lbs
Recommended blower CFM	3,000
Rotor balance	50 gram inches
Standard bearing grease	Mobil Unirex EP 2 *
Megger resistance	20 M $\Omega$

\* Others available upon request.

\*\* With ball bearings; roller bearings reduce maximum speed.

\*\*\* 690V maximum...consult factory.

## Dimensions

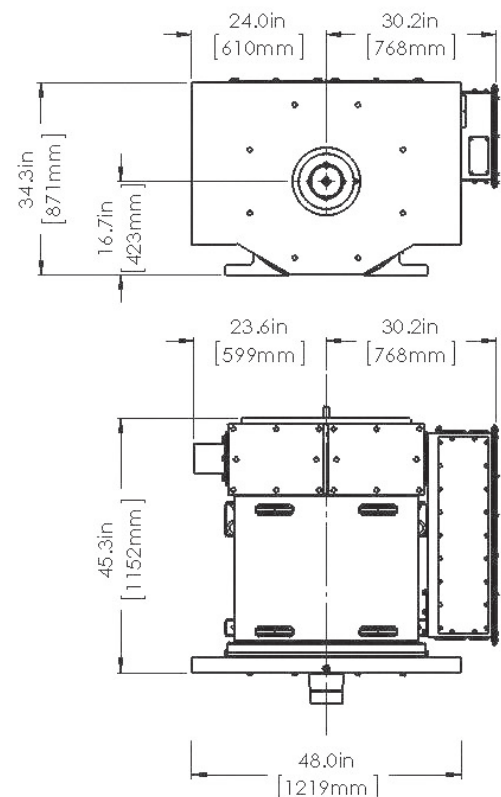

**Ward Leonard**

Excellence in Motor and Control Solutions™

Ward Leonard is a global provider of highly engineered motors, controls and integrated solutions that power Oil & Gas exploration. We provide benchmark performance, productivity, durability and customer support primarily for Top Drives, Mud Pumps, Draw Works, Rotary Tables, Engine Controls and Control Houses. Learn more at [www.wardleonard.com](http://www.wardleonard.com).

401 Watertown Road, Thomaston, CT 06787

P: 860.283.5801 | F: 860.283.5777 | [sales@wardleonard.com](mailto:sales@wardleonard.com) | [WardLeonard.com](http://WardLeonard.com)